





Versatility defined.

Simple freestanding modules combine together to create high performance lab settings. Originally designed by a team of architects, designers, and scientists to meet the changing needs of today's modern scientific laboratories, Steelcase's Lab Bench offers a flexible modular solution for use in wet or dry laboratory settings. Modules easily assemble and reconfigure according to changes in research direction, personnel and individual workstyles.

Laboratory spaces must meet the needs of researchers today and in the future. Lab Bench embraces an architecture and technology infrastructure as essential elements of its design, ensuring that the functionality and aesthetic needed for today, can be adjusted in the future with unprecedented ease.

Key component

- 1 Frames - Link horizontally to create a visual division of the space. The frames support other components, and accommodate electrical, plumbing, and cable routing.
- 2 Worksurfaces - Provide the primary work area. Includes worksurfaces, backsplashes, and sidesplashes
- 3 Storage Components - Attaches overhead to the frame, or beneath the worksurface. Includes overhead and base storage, sink cabinets, and shelves. Slatwall accommodates a range of Details Worktools.
- 4 Power and Communication Elements - Includes power blocks, receptacles and harnesses

Manage space strategically

- Entire modules can be added or taken out at any time to support changes.
- Worksurfaces can be adjusted to 30" or 36" in height and can be supported by either cantilevers, lower storage or a combination of both.
- Shelves and overhead cabinets are completely adjustable in 1" increments.

Utility without sacrificing flexibility

- Utilities (data, electrical, gas, water, etc.) are routed through vertical and horizontal chases, and are fully accessible from a variety of locations in the floor, ceiling or wall.
- Designed to accommodate other lab components such as fume hoods, sinks, and drying racks.



Laboratory Solutions **Abbreviated Statement of Line**

Vertical Structure

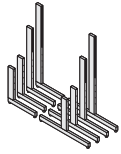

Outside Uprights

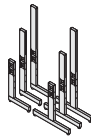

Intermediate Uprights

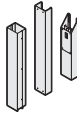

Vertical Utility Chases

Horizontal Structure

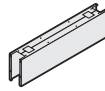

Bridge Channel
Widths: 34", 40", 46", 58"

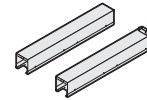

Utility Rails
Widths: 34", 40", 46", 58"

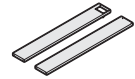

Top Stretchers
Widths: 34", 40", 46", 58"

Worksurfaces

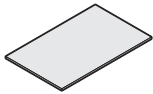

Laminated, Chemsurf, and Phenolic resin
Depth: 24", 30"
Widths: 36", 42", 48", 60", 66", 72"

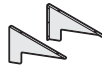

Cantilevers
Depth: 24"
Height: 24", 30"



End Panels
Depth: 20", 26"
Height: 24½", 29½"

Storage

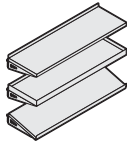

Flat, Gravity Feed, and Seismic Shelves
Widths: 36", 42", 48", 60"

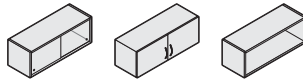

Steel & Laminate Overhead Storage Cabinets
Open, Sliding Glass Doors, Steel and Laminate Hinged Doors.
Widths: 36", 42", 48"
Height: 15", 24"

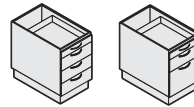

Steel & Laminate Storage Cabinets
(Variety of configurations)
Widths: 16", 18", 24"
Height: 29", 35"

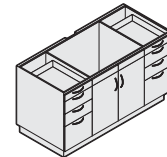

Steel & Laminate Sink Cabinets
Widths: 36", 48", 52", 64"
Height: 35"

Laboratory Solutions also includes: Fume Hoods, Fixtures & Accessories

Surface Materials

Standard Performance Laminate Colors: 225T Frosty White, 286T Fog, 273T Sand, 25T1 Winter on Maple, 26T1 Natural Cherry, 247T Black

Standard Paint Colors: 4790 Sodium, 7236 Fog, 7225 Sand, 7237 Slate, 7238 Fieldstone, 7207 Black

Phenolic Resin: Black Chemsurf: Black 24CT

Global Dealer Network

We speak your language. Over 400 Steelcase dealers in North America, plus more than 500 Steelcase dealers internationally, help you create inspiring workspaces just about anywhere. Whether your project is across town, across the country, or across the ocean, our dealer network will coordinate the logistics so you don't have to. It's local expertise with a global reach.

Steelcase and Dealer Services

It's more than a product, it's a partnership. Our service offering includes workspace evaluations, space planning, project coordination, installation, maintenance, asset management, and much more. Tailored web-based solutions make it easy to purchase what you need and manage what you have. And financing alternatives provide flexible leasing options.

Environmental Commitment

Being an environmentally responsible company starts by asking questions. That's why we carefully analyze all our actions and strive to grow more environmentally effective each day. This means considering the entire life cycle of our products – from raw materials to the day that product is no longer needed. And when that day does come (many years from now) the Steelcase Environmental Partnership program will connect you with resources to donate, refurbish, or recycle your unused Steelcase products. Laboratory Solutions carries the Scientific Certification Systems Indoor Advantage™ certification for indoor air quality in North America.

Call 800.333.9939 or
visit steelcase.com

Steelcase®

Do what you do better.™